



40 Huntingwood Drive Huntingwood NSW 2148

Phone: (02) 8825 1999 Website: [www.aeroflowperformance.com](http://www.aeroflowperformance.com)

# **INSTRUCTION MANUAL**

## **AEROFLOW PERFORMANCE**

### **H FRAME ENGINE STAND**



## **WARNING!**

BEFORE PROCEEDING WITH INSTRUCTIONS PLEASE READ CAREFULLY AND UNDERSTAND BEFORE ATTEMPTING TO USE THIS PRODUCT.

### **INTRODUCTION**

Congratulations on your purchase of the Aeroflow Performance H Frame engine stand. Aeroflow Performance products cannot and will not be responsible for any damage, or other conditions resulting from misapplication of the parts described herein. However, it is our intention to provide the best possible products for our customer, products that perform properly and satisfy your expectations. Should you have any questions? Please call technical support at +61 2 8825 1900 and have the product part number on hand when calling.

Any engine mechanic whether it's at home or at the workshop will know the dilemmas associated with working on an engine when it has been removed from its mounted position in the car. This is where the Aeroflow Performance range of engine stands comes into its own. These engine stands are the key to keeping your engine at working level so you don't fatigue while putting the hours in to your pride and joy. All engine stands feature a 360-degree rotational mounting plate. Allowing the engine to be rotated upside down without compromising the balance of the stand with a locking pin that prevents the motor from rotating further while working on it. This mounting plate has adjustable universal mounting points allowing bolts to be put through and mounted to the rear of the engine making it suitable for most engines. This all-steel construction engine stand also sits on castor wheels allowing easy movement and is powder coated black for protection.

**DO NOT exceed the maximum capacity of 1000lb (453kg)**

**Use only on a hard level surface**

**Always lock the mounting plate rotating mechanism before applying a load**

**Never attempt to move a loaded stand across floors that have cracks or other obstacles which might impede movement of the wheels**

**Never work directly under a supported engine**

**Be sure the engine and stand are stable before commencing work**

**Inspect the stand is in good working condition, not worn, and not missing parts before each use**

**Do not use when tired and or under the influence of Drugs and Alcohol**

**Children are not allowed to use. When stored keep out of reach of children**

**Stay alert. Use caution and common sense when using the Engine stand**

**Always check all bolts and moveable parts are secure before mounting engine and use**

**Failure to follow these instructions and warnings may result in damage to the equipment and or serious personal injury**

**Tools Required:** 19mm Spanner, 22mm Spanner, or adjustable wrench, Snap ring pliers



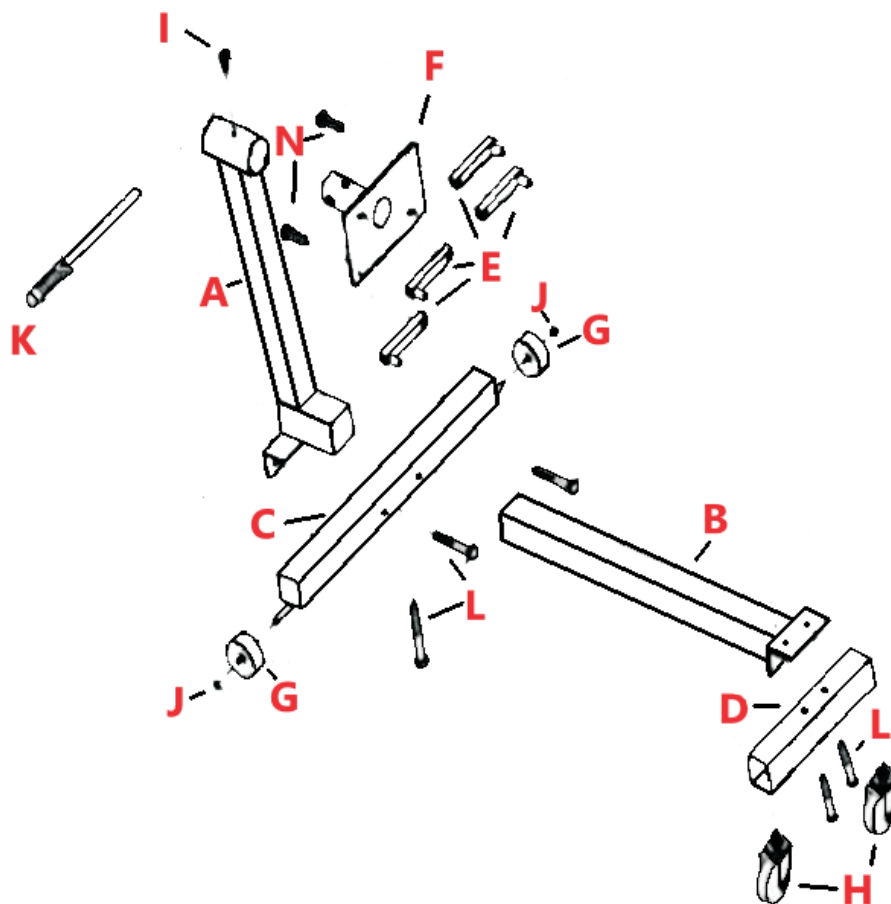

Index	Part	Qty
A	Main Frame	1
B	Cross Member	1
C	Rear Leg	1
D	Front Leg	1
E	Mounting Arm	4
F	Mounting Plate	1
G	Wheels	2
H	Swivel Wheels	2
I	Locking Pin	1
J	Snap Rings	2
K	Handle	1
L	M12 Bolt	5
M	M12 Washer, Nut	7
N	M14 Bolt, Washers, Nut	4

## INSTRUCTIONS

1. First grab the M12 Bolts (L), washer and nuts(M) and keep the M14 Bolts, washers, nuts (N) aside as these 4 are used for the Mounting Arms(E). Now with the Main Frame (A) attach the Rear Leg (C) with the M12 hardware (L,M). Make sure the wheel brackets are on the underside and towards the front.

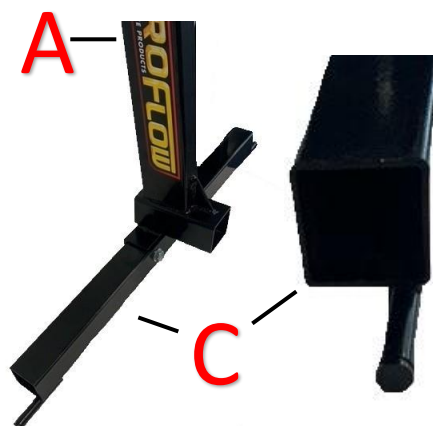

2. Slide the Cross Member (B) into the bottom of the Main Frame (A), keep the two bolt holes for the Front Leg facing up. Make sure the holes line up in the Main Frame. Insert a bolt from the underside, nut from the top and tighten.

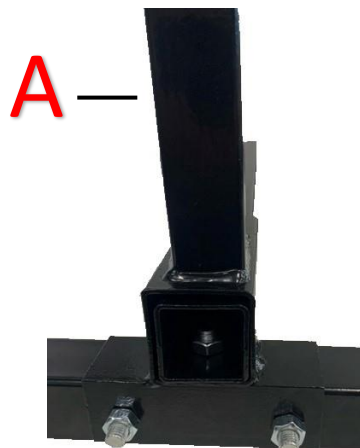
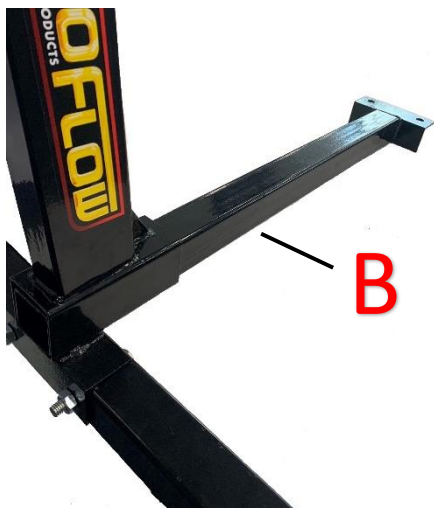

3. Now with the Front Arm (D) you can attach the Swivel Wheels (H) with two M12 nuts and washers (M)

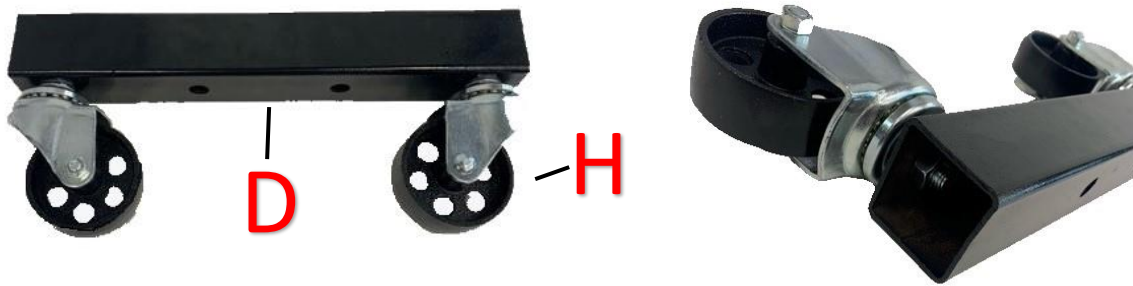

4. You can now attach the Front Arm (D) to the Cross Member (B) with M12 Hardware (M,L)

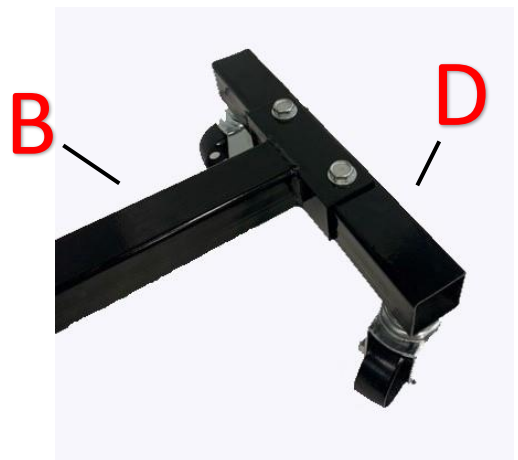

5. Slide the Wheels (G) onto the brackets of the Rear Leg (C). You will then need to put the snap rings (J) in the notch to secure the wheels.

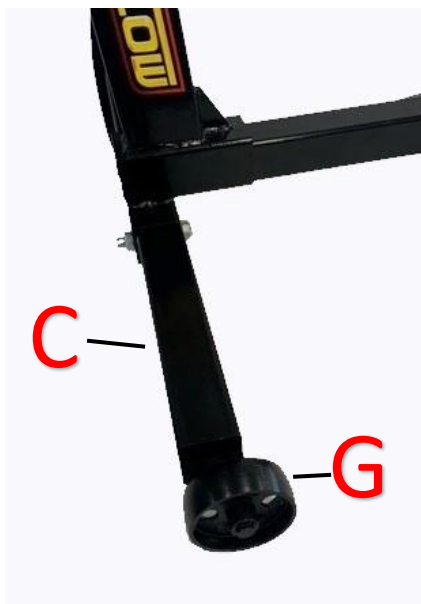

6. With the Mounting Plate (F) you can attach the Mounting Arms (E) with the M14 (N) set

**Note:**

**We recommend fastening the Mounting Plate and Arms to the engine first. Then sliding the Mounting Plate and engine into the Main Frame.**

**Engine mounting bolts are not supplied, you will have to supply your own engine mounting bolts.**

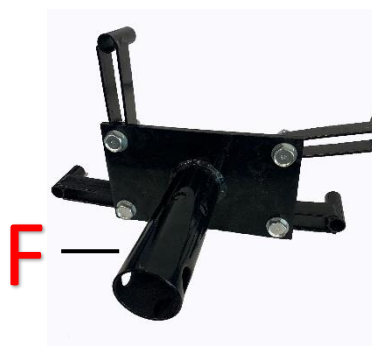
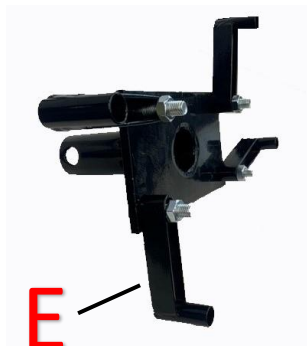

7. Once the Mounting Arms are attached you can now slide the whole Mounting Plate (F) into the main frame (A). Use the Locking Pin (I) to secure the Mounting Plate. Insert the Handle (K) in the back of the Mounting Plate. To rotate the Mounting Plate, you will have to lift the Locking Pin out and rotate with the Handle then insert the Locking Pin back in to secure the Mounting Plate.



*For more information or technical enquires*

*Contact: AeroFlow Performance on*

*Phone: (02) 8825 1979 Website: [www.aeroflowperformance.com](http://www.aeroflowperformance.com)*